

MEGA CONSTRUCTION PRO-WORKSHOP SET

- Please **READ** these instructions first, it only takes a few minutes,
- This sheet explains how to use the tools and explains the symbols used in the project instructions.
- You can also go to www.megaconstruction.co.uk to see a video of how to use the tools and watch each model being built up piece by piece which you can pause and rewind.



All the tools are completely safe and are designed for cutting foam tubes.

The models are made up from 3 tube sizes, you will see these referred to as **(L)** for large, **(M)** for Medium and **(S)** for small.

TOOLS

MEASURE

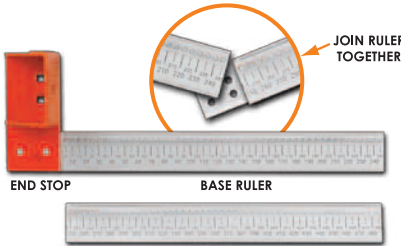

SAW CUTTING

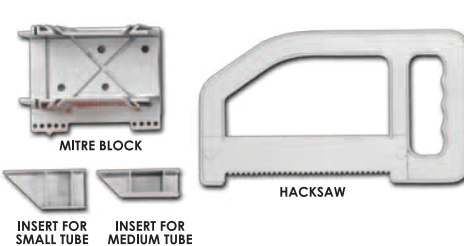

HOLE CUTTING

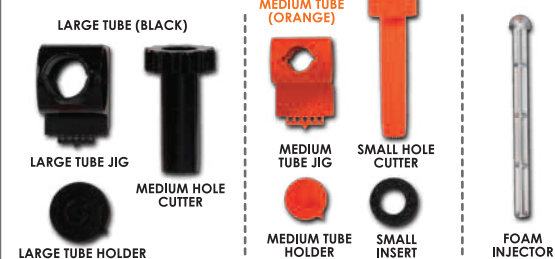

SLOT PUNCHING



SAW CUTTING

(L) LARGE TUBES

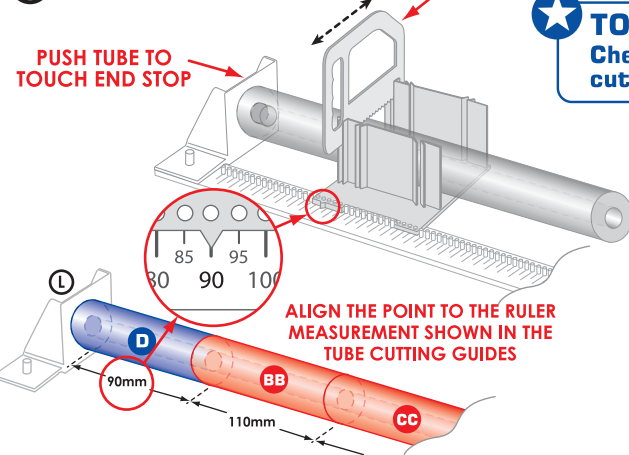

(M) MEDIUM TUBES

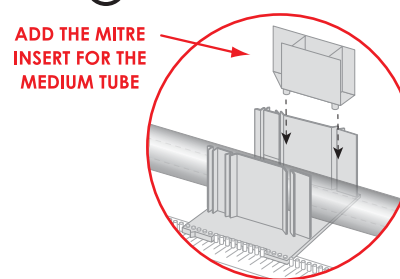

(S) SMALL TUBES

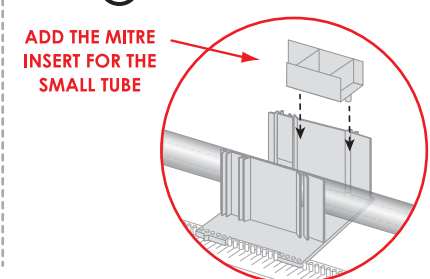

- When cutting, hold the tube steady with your free hand.
- On the back of this sheet you will find the tube cutting guide for your project.
- **Before cutting each length, DOUBLE CHECK** you have the right size tube and the pointer is at the correct measurement.
- Put the corresponding sticker on the end of the tube after each piece is cut.

HOLE CUTTING - MATCH THE ORANGE AND BLACK COLOUR TOOLS TO THE INSTRUCTIONS

(L) LARGE TUBES

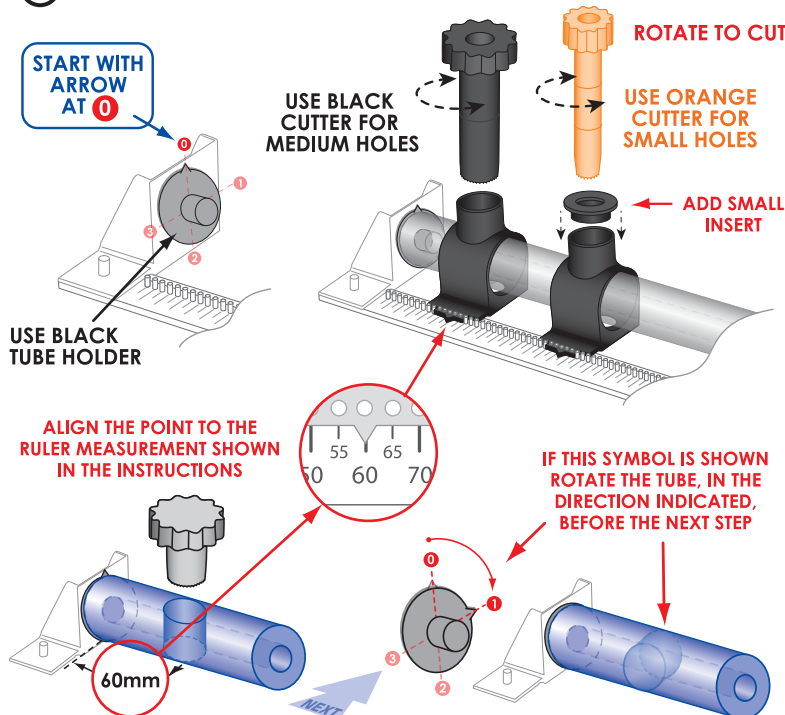

(M) MEDIUM TUBES

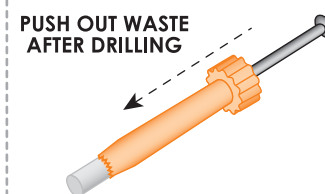
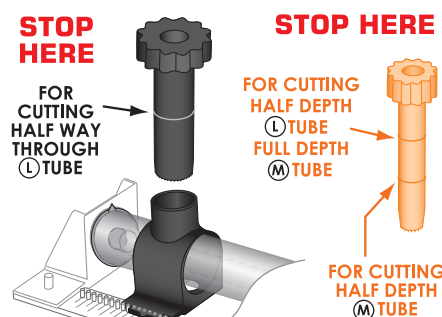
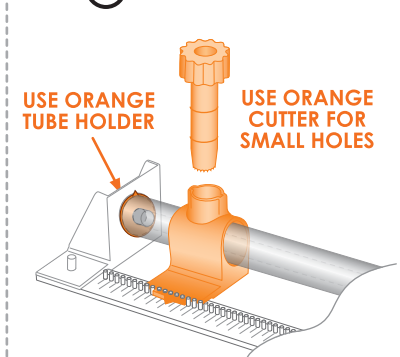

DRILL ALL THE WAY THROUGH

TO ASSEMBLE
TWIST THE TUBE LEFT AND RIGHT AS YOU
PUSH IT THROUGH THE DRILLED HOLE

TOP TIP
When cutting half depth medium holes, drill a small hole first, then a medium. You can use your finger to pull the remaining ring out.

- You can drill **Medium and Small holes** in the **(L)** Large tube and **only small holes** in the **(M)** Medium tube, you **CANNOT drill holes in the Small tube**.
- **Before** you cut each hole **DOUBLE CHECK** the tube holder arrow is in the correct position (0,1,2 or 3), the pointer is on the correct measurement, you have the correct drill size and the depth the drill needs to go.